

**STANHOPE BOROUGH BOARD OF EDUCATION  
2022 OFFICIAL SPECIAL SCHOOL ELECTION SAMPLE BALLOT**

In cases where the Sample Ballot is to be sent to an addressee who does not receive his mail by delivery to his home or through rural free delivery if not delivered within 5 days return to the County Board of Elections and in all other cases if not delivered within 2 days return to County Board of Elections.



Non-Profit  
U.S. POSTAGE  
**PAID**  
New Brunswick, NJ  
Permit No. 1

DO NOT FORWARD – RETURN POSTAGE GUARANTEED

COUNTY BOARD OF ELECTIONS  
83 Spring Street, Suite 305  
Newton, NJ 07860

RETURN SERVICE REQUESTED

**Tuesday, December 13, 2022**

**POLLING LOCATION**

Accessible Polling Location **POLLS OPEN 6 A.M. TO 8 P.M.**

STANHOPE BOROUGH - BOARD OF EDUCATION

# QUICK & EASY VOTING IN SUSSEX COUNTY

ES&S ExpressVote

HOW TO USE TOUCH SCREEN VOTING

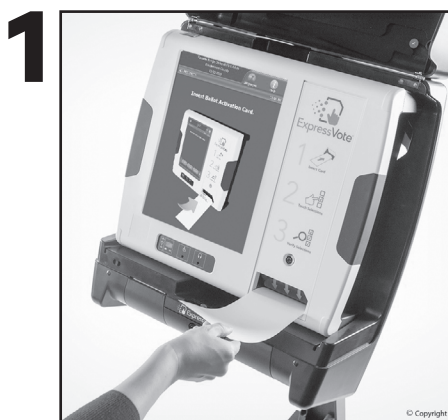

## 1 Activate Your Ballot

To begin your voting session, take the *Ballot Activation Card* given to you by the poll worker and insert the card into the ExpressVote's Activation Card Slot.

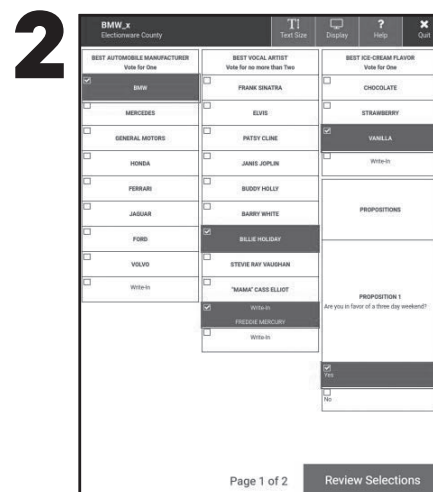

## 2 Vote Your Ballot

On the voting screens, touch the candidate of your choice. To vote for someone not on the ballot, touch **Write-in** and use the on-screen keyboard to enter your write-in name. When done, touch **Accept**. When voting a public question, select either a **YES** or **NO** response.

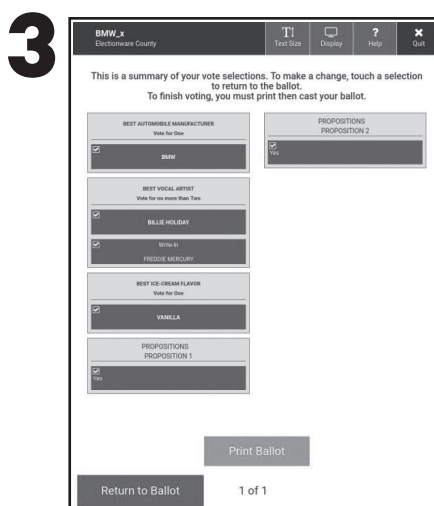

## 3 Reviewing Your Vote Selections & Casting a Ballot

Once all selections have been made, a summary of your voted selections will appear. Review your selections; if needed, touch the contest for which you wish to make changes. Make the desired changes and return to the summary review screen.

When done verifying selections, touch **Print Ballot** and then **Print** to print your voted selections onto the ballot activation card. Take time to review the information on the card to make sure your selections were recorded accurately. Place your voted card into the privacy sleeve provided by election staff and proceed to the tabulation scanner.

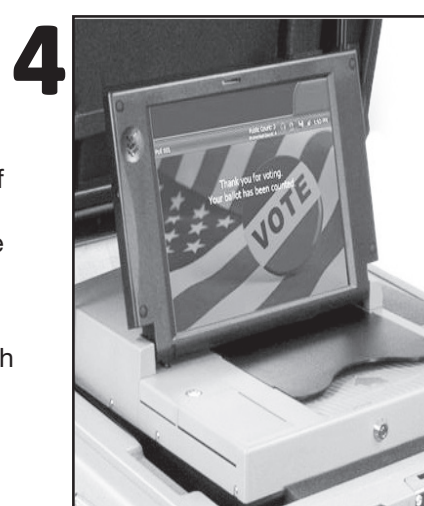

## 4 Insert Your Voted Ballot Card into the Tabulation Scanner

**Your ballot is not counted until it is inserted into the tabulation scanner.**

Remove your ballot from its privacy sleeve and insert the card into the tabulation scanner. The card is deposited into a secure ballot box and is retained by the Board of Elections.

A "Thank You for Voting" screen confirms your ballot has been counted.

To adjust the screen display, touch the buttons in the upper right corner of the screen.

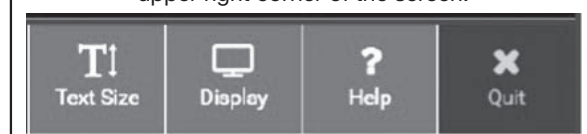

# OFFICIAL SPECIAL SCHOOL ELECTION SAMPLE BALLOT

THIS BALLOT CANNOT BE VOTED. IT IS A SAMPLE COPY OF THE OFFICIAL SPECIAL SCHOOL ELECTION BALLOT USED ON ELECTION DAY.

## TUESDAY, DECEMBER 13, 2022



ELLEN HORAK, Municipal Clerk

Official Ballot  
Special School Election  
December 13, 2022  
Stanhope Boro

✕ Quit

? Help

Display

Text Size

### MUNICIPAL SCHOOL

#### STANHOPE BOROUGH BOARD OF EDUCATION BOND PROPOSAL QUESTION

The Board of Education of the Borough of Stanhope in the County of Sussex, New Jersey is authorized (a) to undertake various improvements, alterations, renovations, repairs, and upgrades at Valley Road School, including related work, fixtures, furniture, equipment and any site work; and (b) to appropriate \$5,985,000, and to issue bonds in an amount not to exceed \$5,985,000.

The final eligible costs for the projects approved by the New Jersey Commissioner of Education are \$5,985,000. The project includes \$0 for school facility construction elements in addition to the facilities efficiency standards developed by the Commissioner of Education or not otherwise eligible for State support pursuant to N.J.S.A. 18A:7G-5(g). The State debt service aid percentage will equal 40% of the annual debt service due with respect to the final eligible costs of the projects financed with bonds. The Board of Education is authorized to transfer funds among the projects approved at this election.

Do you approve this Bond Proposal Question?

Yes

No

## ATTENTION VOTER!

**Before you head to the polls, know your voting rights. Scan this code with your mobile device, or visit:**

<http://sussexcountyclerk.org/elections/nj-voters-bill-of-rights/>



There is no EARLY VOTING period available for this election. Voters should go to their assigned polling place on Election Day to vote; see red box on front of mailer for polling location and hours. Familiarize yourself with this ballot and voting instructions. It will assist you in voting and save you time at the polls.

## DID YOU ALREADY RECEIVE A VOTE-BY-MAIL BALLOT?

If you already requested and received a vote-by-mail ballot, don't delay in returning your voted ballot. Ballots must be received by the County Board of Elections by close of polls on Election Day, or within 6 days of Election Day if received by mail provided that the ballot envelope bears a postmark no later than Dec. 13, 2022.